

Top Spline:
 8d box (0.113) in two rows
 3" o.c. both sides of joint.

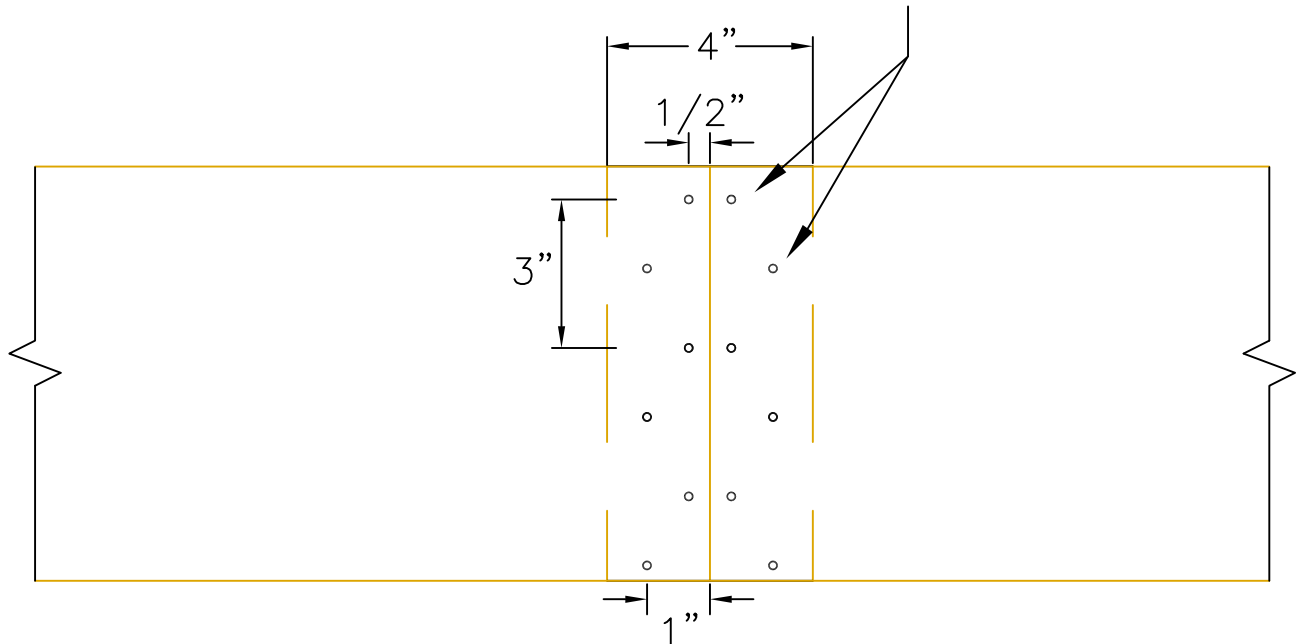

PLAN

Scale: NTS

Note: Spline to be of material conforming to DOC PS2, min thickness 7/16".

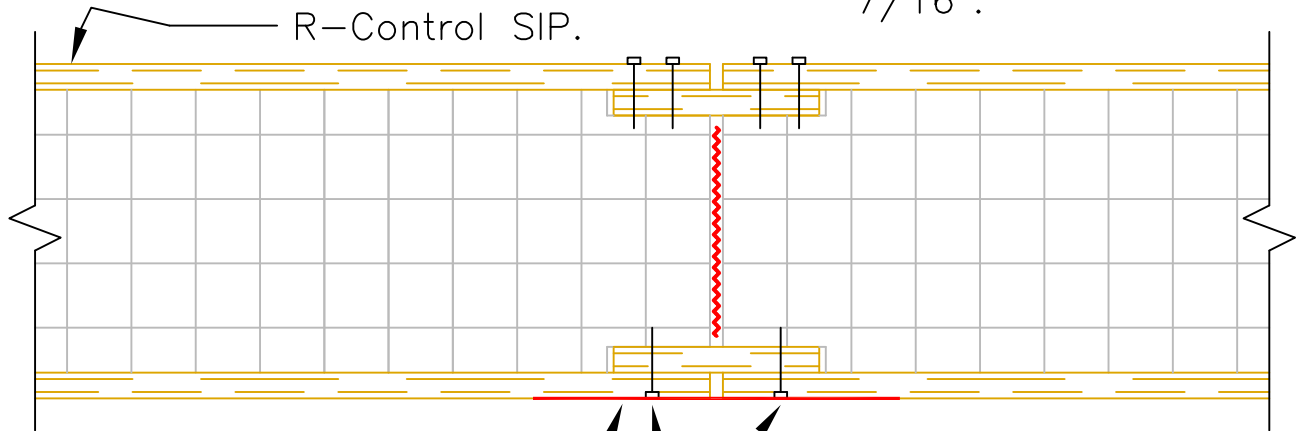

SIP Tape or equivalent vapor retarder located interior or exterior per climate conditions or code requirement.

Bottom Spline:
 8d box (0.113) nails
 6" o.c. in single row
 both sides of joint.

SECTION

Scale: NTS

Updated 1-16-12

R-Control® SIP

TITLE: Diaphragm Connection
 - Splines

NO.
 SIP-139a