

Note: roof covering & underlayment as req'd by code.

R-Control Wood Screw, see SIP-135 for spacing requirements.

R-Control SIP roof.

SIP Tape or equivalent vapor retarder located interior or exterior per climate conditions or code requirements.

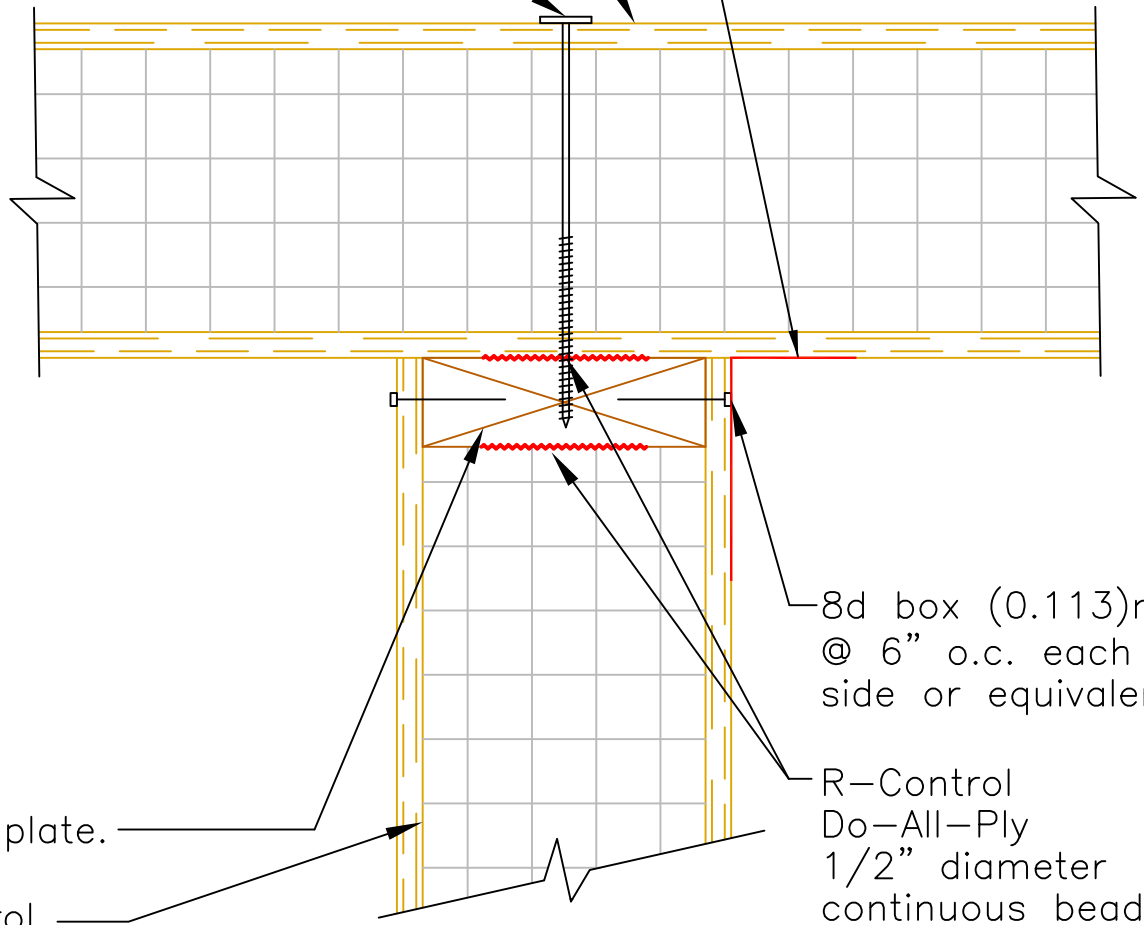

2X top plate.

R-Control SIP wall.

8d box (0.113)nails @ 6" o.c. each side or equivalent.

R-Control Do-All-Ply 1/2" diameter continuous bead.

## SECTION

Scale: NTS

Updated 3-16-12

R-Control® SIP

TITLE:  
Gable End

NO.  
SIP-122c